



Order No. 4.24173 Baby Elephant



Order No. 4.24175 Lion

Play value

Our three artistically designed animal babies, Lion, Elephant and Rhinoceros, create a friendly atmosphere and are instantly accepted by children. Without needing any encouragement at all, they play riding games, pat their faces and pull on their tails.

Play sculptures such as these are particularly well suited to accentuate children's worlds and strengthen the identity of a space. These installations create a welcoming atmosphere for entrance areas to kindergartens, children's hospitals and similar institutions.

Fundamental characteristics

- Very special appeal
- Eye-catcher of a play area
- Attractive meeting point
- Incentive for playing: curiosity, role-playing games, experiencing closeness
- Movement: climbing up

Recommended for

- Kindergarten children
- Supervised play areas, such as kindergartens, schools, after-school programmes or similar
- Public play areas without supervision, such as playgrounds, parks or similar



Order No. 4.24176 Rhinoceros

**Baby Elephant
Lion
Rhinoceros**



Order No. 4.24176 Rhinoceros

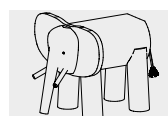

4.24173

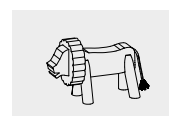

4.24175

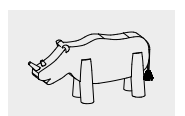

4.24176

Order No. 4.24173
Baby Elephant

Safety distance →
 Device dimensions —●—
 Functional distance —|—

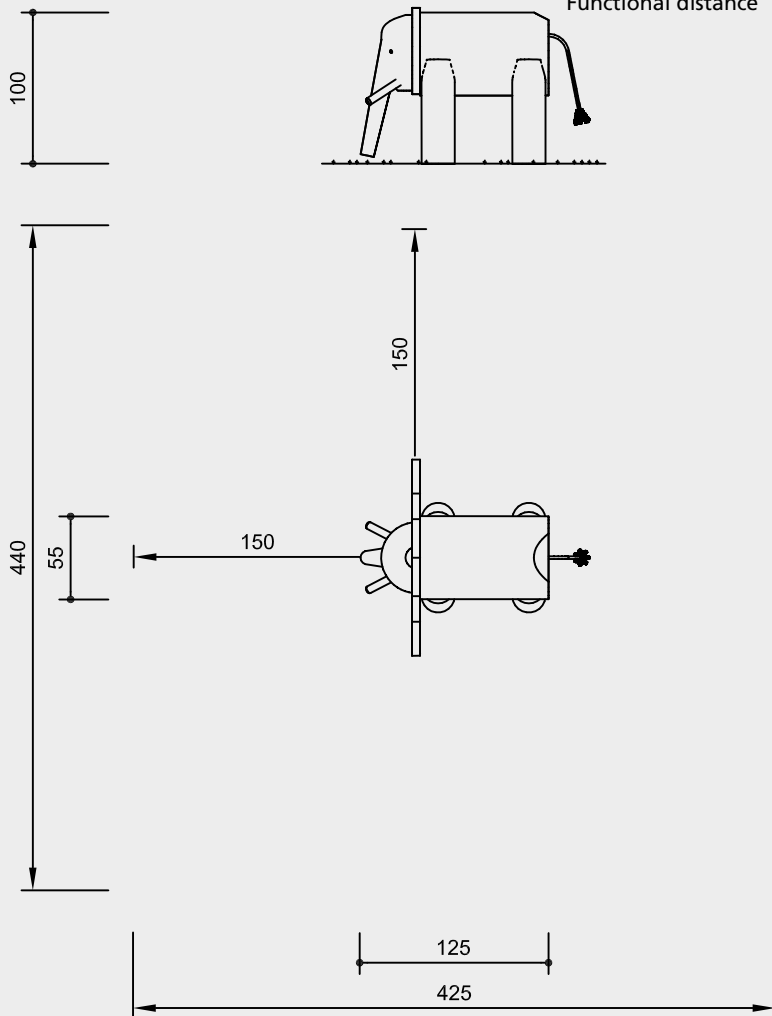
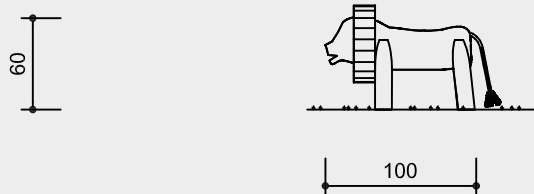
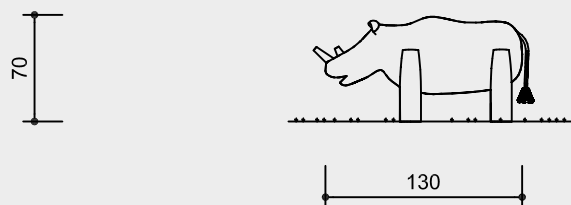
Order No. 4.24175
Lion

Order No. 4.24176
Rhinoceros

Scale 1:50

Safety check according to DIN EN 1176

Technical information

Equipment made of mountain larch

Peeled white

Palisades peeled white means that bark, cambium and sapwood are removed, the natural shape of the trunk is preserved and can be experienced

Core-free

Sawn-timbers core-free, thus decreasing occurrences of cracking and undesired changes in shape

Ground anchor

All parts used for anchoring to the ground are made of hot-dip galvanised steel or stainless steel



Tail made of PP rope, Ø 16 mm, 3 strands, weather-resistant, standard colour: natural

Order No. 4.24173 Baby Elephant

As above, but in addition with

Plywood

Plywood made of mountain larch, three-layer (3 cm) or five-layer (4 cm). High dimensional stability, waterproof, glued according to DIN EN 13353:2011



For more detailed explanation of the quality characteristics see price list.

Dimensions

Order No. 4.24173 Baby Elephant

Height	1.00 m
Length	1.25 m
Width	0.55 m
Weight	200 kg

Order No. 4.24175 Lion

Height	0.60 m
Length	1.00 m
Width	0.45 m
Weight	60 kg

Order No. 4.24176 Rhinoceros

Height	0.70 m
Length	1.30 m
Width	0.40 m
Weight	100 kg

Components

1 Animal and 4 foundation irons each

Installation information

Surfacing requirements corresponding to a fall height of ≤ 1.00 m (please refer to price list for more detailed information)

Foundations

Order No. 4.24173 Baby Elephant

2 items 90 x 30 x 30 cm
 Excavation depth 50 cm

Order No. 4.24175 Lion

2 items 80 x 30 x 30 cm
 Excavation depth 50 cm

Order No. 4.24176 Rhinoceros

1 item 90 x 60 x 30 cm
 Excavation depth 50 cm

Attention:

**Exact measurements may vary;
 for all installation dimensions refer to current assembly instructions.**

Technical changes reserved.

4.24173

4.24175

4.24176